

## Fibre King Case Packers

➤ Fibre King Case Packers are used globally by some of the biggest names in food, beverage, pharmaceutical, FMCG and petrochemical. They're reliable, accurate and easy to use.

Here's a range of case packers that will deliver **maximum flexibility**, with fully customisable features. Heavy duty construction makes them suitable for 24 hour a day production facilities. Fast and repeatable changeovers deliver maximum line uptime. Clean, open design means easy operator and maintenance access.

At Fibre King, we don't just build machines – we engineer peace of mind. Call us on **+617 3293 8800** to see how we can help you.

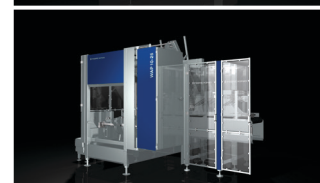
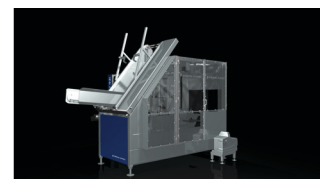

# Case Packer Features

The following information is provided as a guide to the features and capabilities of the Fibre King range of case packing equipment.

Descriptions are applicable to the various models of case packer 'heads'. Infeed and collation modules are specific to each application and are fully customisable, for an economical price. The entire range features:

### Fully Automatic Operation

Speeds are indicated by model description.

### Heavy Duty Construction

Our Case Packers are designed for use in **24 hour per day production environments**, for a serviceable life of in excess of 15 years.

### 304 Stainless Steel

Frames and sheet metal as standard, 316 stainless steel is available as an option for highly corrosive products or cleaning agents.

### Quick Changeover Times

Changeovers are fast and repeatable. Motorised changeover of major components is available as an option.

**Colour Touchscreen** with full monitoring of machine status and diagnostics. Internet access enables our engineers to provide **exceptional levels of remote support**.

### Quiet Operation

Less than 80dB.

### Clean and Open Design

Easy operator and maintenance access.

### Robust Guarding

Electrically interlocked to AS4024.1 or equivalent International Standard. Give your staff the best protection and maximise uptime with **quick access** for setting up and clearing obstructions.

### Reliability and Spare Parts Availability

Only high end proprietary items are used ensuring **reliable performance and immediate availability of spare parts**. Festo, SICK, SEW Eurodrive and Nordson are examples, though we are happy to use customers site standards.

# Robotic Case Packer

## RCP – Robotic Case Packer

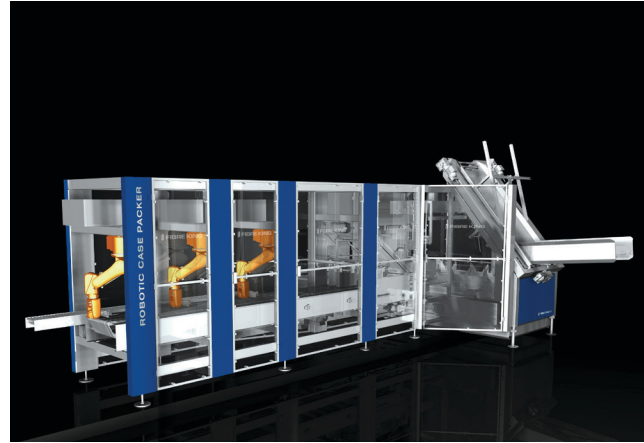

### Standard model features:

- Combined robotic technology using Fibre King proven product handling and collation with ABB's IRB120 robot.
- Capable of up to 60 picks per minute and up to 3kg payload. System accepts pre-formed cases/trays and can be coupled with any case erector.
- Handles a wide range of products with proven mechanical collation and options for conveyor tracking and vision system.
- Custom End-Of-Arm tooling to suit your application with quick changes for multiple production types.
- Extremely compact design. Can fit into existing manual packing space. Flexible layout options for product and case handling conveyors. Easily scalable design for higher throughput lines.
- Advanced Control System – the latest design motion control technology for high performance accuracy and speed with optimised path generation for the shortest possible cycle time.

## Case Types Robotic

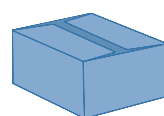

> RSC

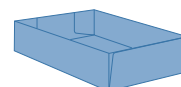

> Tray

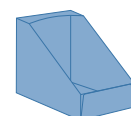

> Shelf Ready

# Intermittent Motion

## WAP 10-25 – Wraparound Case Packer Range

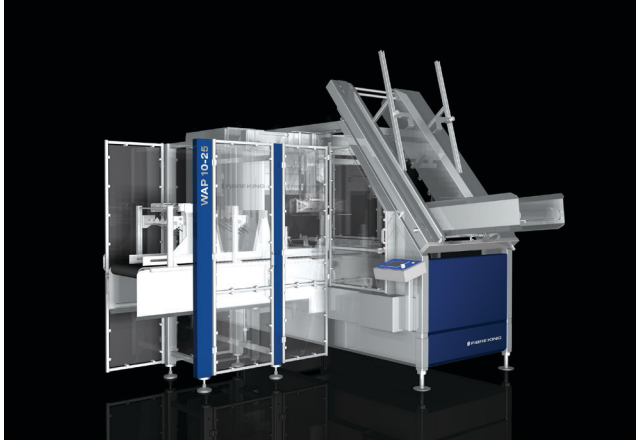

### The base model features for both machines:

- Compact footprint.
- Option to run tray and case or shelf ready.
- NordsonP4/ P7 hot melt applicator (or equivalent), can be upgraded to larger sizes if required.
- Standard operator interface is via a colour touchscreen.
- Standard hopper style magazine (WAP10-15) will hold 150–200 blanks this can be upgraded to a high capacity magazine holding 350–400 blanks (WAP20-25).

### WAP 10-15 – Wraparound Case Packer

- Maximum operating speed 10–15 cases per minute, infeed/collation dependent.
- A geared motor with variable speed drive on the case transport system, pneumatic drive on the vacuum arms and a pneumatic product loader.

### WAP 20-25 – Wraparound Case Packer

- Maximum operating speed 20–25 cases per minute, infeed/collation dependent.
- A servo motor drive on the case transport system, geared motor drive on the vacuum arms, servo motor drive on product loader horizontal motion, pneumatic or servo on vertical motion.

## Variations & Options WAP10-25

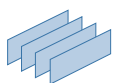

Multi-Lane Feed

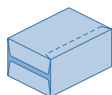

Internal Manufacturer's Flap

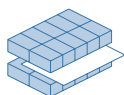

Layer Pad Insertion

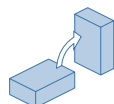

Product Inverter



Non-Round Product

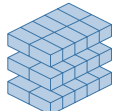

Multi-Layer Stacking

# Continuous Motion

## WAP30-45-60 – Wraparound Case Packer

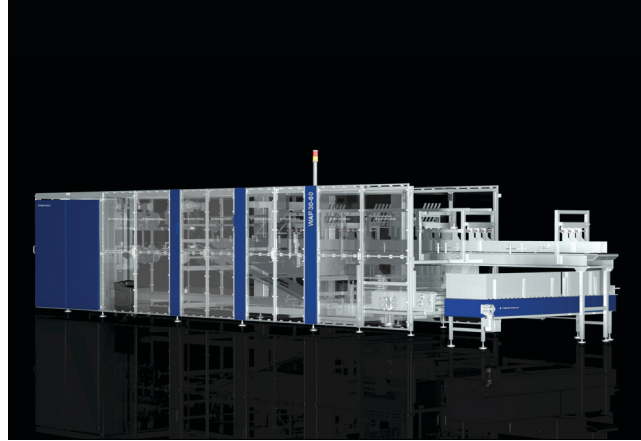

### The top of the range model features:

- Maximum operating speed 30/45/60 cases per minute, infeed/collation dependent.
- 304 stainless steel construction as standard.
- Option to run tray and case or shelf ready.
- Motorised changeover of major components as standard.
- High capacity magazine holding 800–1000 blanks, with unlimited capacity to expand.
- Nordson P10 hot melt applicator (or equivalent), can be upgraded to larger sizes if required.

## Case Types WAP10-25/30-60

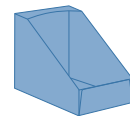
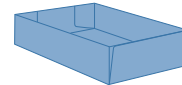
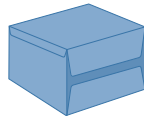

> Wraparound Case and Tray

> Shelf Ready

## Variations & Options WAP30-60



Non-Round Product

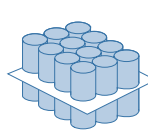

Round Product (Dual Layer)



Bottles (Glass, PET or HDPE)

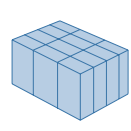

Cartons

## RSC End Load

### RSC15 – End Load RSC Case Packer

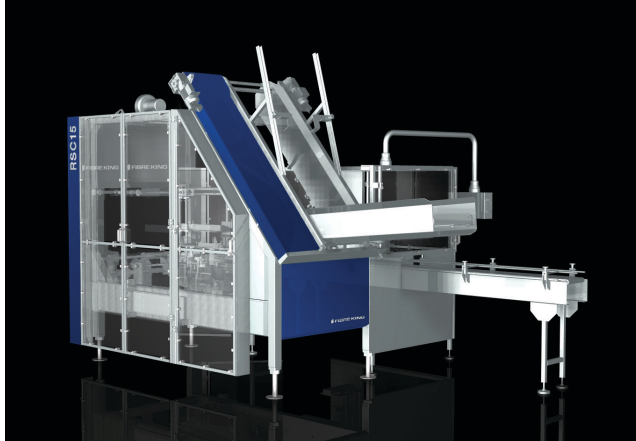

#### Features:

- Maximum operating speed 15 cases per minute, infeed/collation dependent.
- A geared motor with variable speed drive on the case transport system, pneumatic drive on the vacuum arms and a pneumatic product loader.
- Standard hopper style magazine will hold 75–100 blanks. This can be upgraded to a high capacity magazine holding 175–200 blanks.
- Nordson P4 hot melt applicator (or equivalent), can be upgraded to larger sizes if required. Hot melt sealing is standard, tape sealing available as an option.
- Compact footprint.

### Case Types RSC15

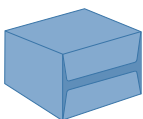

> Regular Slotted Case (RSC)

## RSC Top Load

### RSC – Top Load



#### Features:

- Operating speed of up to 15 cases per minute dependent on case configuration. Dual P&P option available.
- Ideal for multi-product lines with typical changeover times of less than 20 minutes.
- Motorized changeover of major components available as an option.
- Hygienic and open design (no catchpoints, easy access for maintenance).
- Full monitoring of machine status and diagnostics
- Compact footprint.

### Case Types RSC Top Load

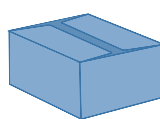

> RSC

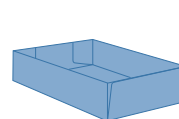

> Tray

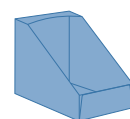

> Shelf Ready

# Little Packer - Cans

## RSC – End Load Can Case Packer

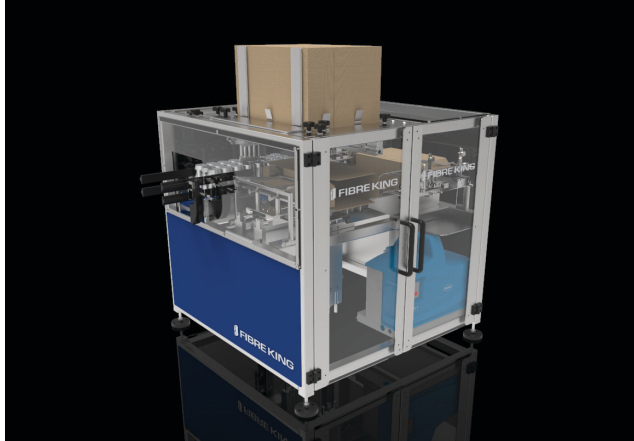

### Features:

Automatic, compact, affordable can casepacker. The 'Little Packer' packs beer cans into an end load RSC carton ready for distribution.

- Up to 5 cases per minute.
- 375ml and 500ml cans.
- 4 or 6 pack clusters with an option to pack loose cans if required and can run both 24 and 16 can cartons.
- 1.2m x 1.2m. Extremely compact design. Can fit into existing manual packing space.
- Budget friendly for quick payback, excellent ROI.
- Easy operator and maintenance access.

## Product Types

Product types currently packed using Fibre King Case Packers:

- **Bottles** – PET, glass, plastic. Round and non-round. 187ml to 5 litres.
- **Jars** – PET, glass. Round and non-round.
- **Cans** – aluminum, steel, cardboard. Single and dual layer, with and without layer pad.
- **Cartons** – single and multi-layer (up to 6 layers).
- **Bags** – block bottom bags of powder. Single and dual layer.
- **Shrinkwrapped packs**
- **Tubs** – single and multi-layer.
- **Pouches**
- **Non-Standard Products** - contact us for more information

## Current Users

Some of the current multi-national references for Fibre King Case Packers:

- **Arnott's Biscuits** (part of Campbell Soups) (cartons)
- **Asaleo Care Australia** (hygiene products)
- **Coca-Cola** (cans, bottles, hot-fill PET and glass, multipacks)
- **Colgate-Palmolive** (cartons and block bottom bags of detergent powder, cartons of toothpaste)
- **Fosters** (cans, glass bottles, multipacks)
- **Fonterra** (tubs)
- **Goodman Fielder** (tubs)
- **Kraft Mondelez** (cartons)
- **Lion Dairy & Drinks** (part of Kirin) (bottles – PET, hot-fill PET, HDPE, glass and gable top cartons)
- **Mars Confectionery** (cartons)
- **Mars Petcare** (cartons)
- **Mobil** (oil bottles)
- **Nestle** (sticks in bag, cartons)
- **Nestle Waters** (PET multipacks)
- **Orlando Wines** (part of Pernod Richard) (glass bottles, wine casks)
- **Parmalat** (bottles and gable top cartons)
- **PZ Cussons** (cartons and block bottom bags of detergent powder, cartons)
- **Reckitt Benckiser** (bottles and tubs)
- **Sanitarium Health Food Company** (cartons)
- **SC Johnson** (aerosol cans)
- **Schweppes** (part of Asahi) (cans, multipacks)
- **Shell** (oil bottles)
- **Simplot** (cartons)
- **Snapfresh** (part of QANTAS) (frozen airline meals)
- **Wyeth** (Nutritional) (cans, cartons, block bottom bags)



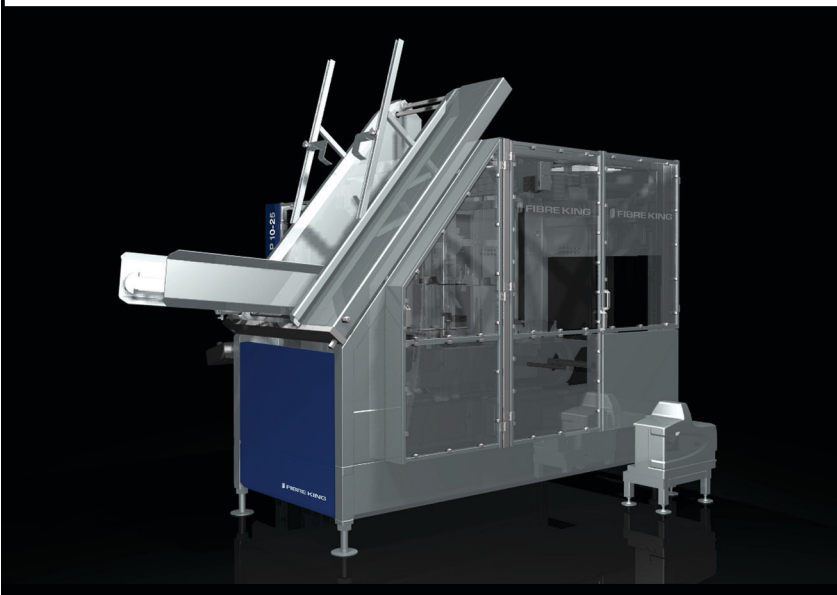
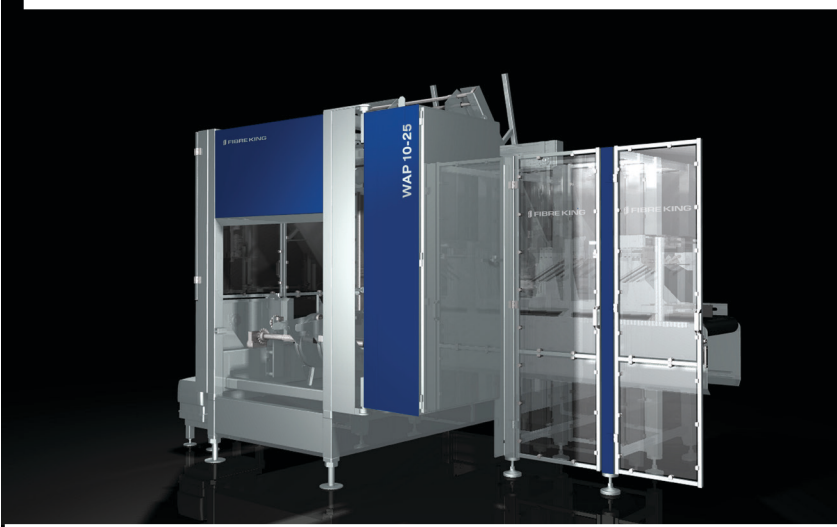
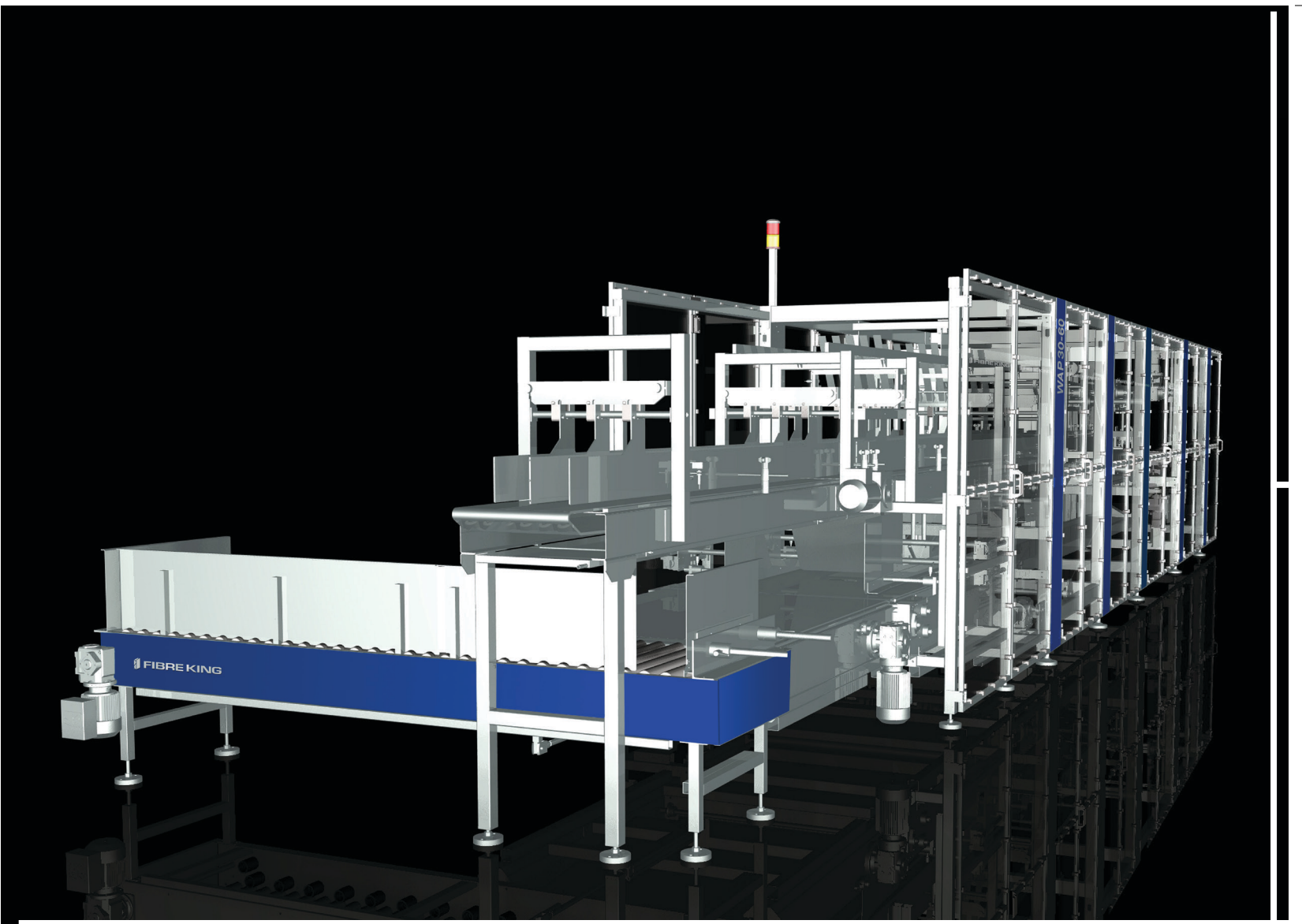

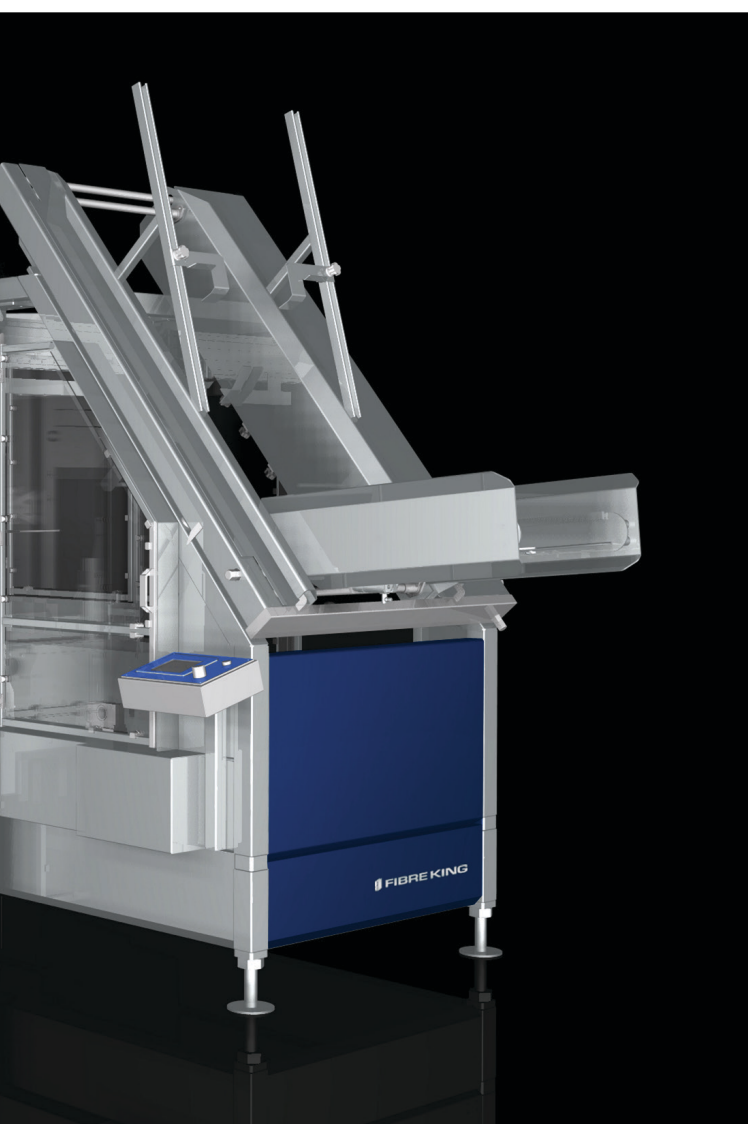
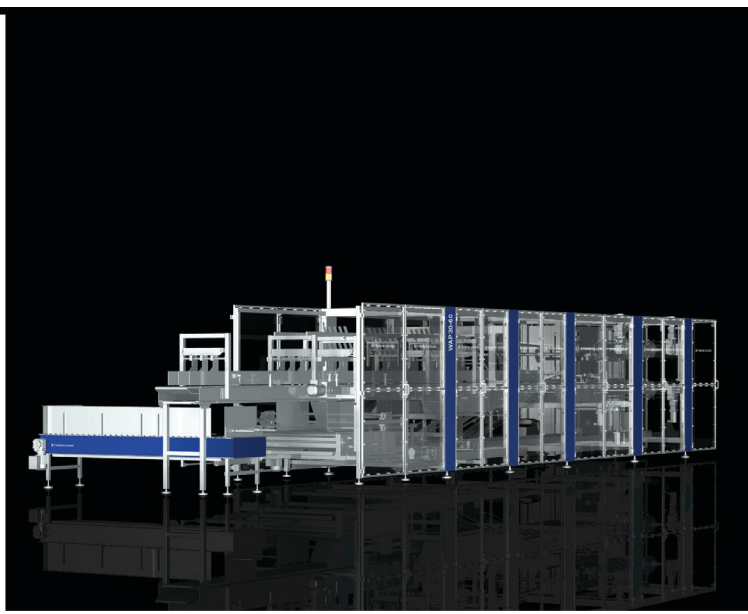

**> Fibre King have delivered a fantastic case packing solution - it really demonstrates their commitment to continuous improvement.**

**Dealing with companies as professional and forward thinking as Fibre King is what motivates me in my job!"**

**Rod Bott  
Plant Operations Manager  
The New Zealand Dairy Co.**

**> "Equipment failure has a significant impact on all our valued customers. We look for reliable, flexible, serviceable products and equipment from our preferred partners - Fibre King consistently meets our demands."**

**Mark Krygger  
Orora Group**

# The Fibre King Difference

## > More Uptime

Fibre King works closely with customers to understand their specific requirements and collaborate to develop a solution that exceeds production expectations. Our equipment combines practical design, robust manufacturing and simple operation providing our customers with a thoroughly reliable machine built to endure constant, rigorous use. Changeovers happen quickly and seamlessly; we build in easy access for maintenance and upgrades. Our remote monitoring, PLC programming and service standards are such that some of the world's biggest companies choose Fibre King as their preferred supplier.

## > Lower Overall Cost of Use

Fibre King uses the best technology available combined with over 90 years of engineering experience to build machines with both the operator and maintenance team in mind ensuring less operator intervention is needed and offering easy maintenance access. Our equipment is designed to be able to integrate with existing production lines as well as being adaptable as requirements change over time. Fibre King has proven results for providing reliable, high quality machinery that stands the test of time with machines in full operation 30 years on. Our solutions provide reduced direct labour costs, improved productivity, increased product quality, increased capacity, and reduced risk of injury.

## > 'No Excuses' Service

Your investment in a Fibre King machine is backed by our full service warranty, operator training and ongoing support. We're on hand to make sure your production line is working at maximum capacity from the date of commissioning, no matter what it takes. Sophisticated remote access means we can monitor performance of our equipment anywhere around the world, and provide immediate technical assistance.

> **“Fibre King’s ability to understand the particular challenges we faced, develop innovative design solutions, execute the build in a timely and cost effective manner and support us through commissioning stage were outstanding”.**

Greg Tunks, Logtek



### Fibre King Australia (Head Office)

9 Oasis Court, Q 4019 Australia  
PO Box 3051 Clontarf DC, Q 4019 Australia  
t. +61 7 3293 8800 f. +61 7 3293 8888

e. [sales@fibreking.com](mailto:sales@fibreking.com) w. [www.fibreking.com](http://www.fibreking.com)

### Fibre King Thailand

Hemaraj Eastern Seaboard Industrial Estate  
500/98 (ZONE D44) Soi.H1/6 Moo 3 T.Ta-Sit A.Pluak Daeng Rayong 21140  
t. +66 33 069 830 - 32 f. +66 33 069 833

